

Low Cost 3 Axis Inclinometer



The **SSY0271** is a low cost **Digital 3-Axis Inclinometer** that affords unparalleled accuracy, quality, reliability and value. Based on a 3-Axis MEMS Accelerometer the **SSY0271** offers a wide angular range, low resolution and operates on a low current (4.5mA) +4.5 to +30VDC Input voltage. The rugged IP66 housing is ideal for harsh industrial applications.

Applications

- Aerospace
- Automotive
- Crane Safety Systems
- Industrial
- Marine Data Buoy
- Platform Leveling

General Specifications

Temperature range -55°C +125°C
Operating range -40°C +80°C
3 axis inclinometer.....Roll (x), Pitch (y)and Yaw (z)
min max
Input Voltage4.5Vdc 30Vdc
Current4.5mA
Resolution 0.01deg
Repeatability.....0.02 deg
Frequency response 2Hz
Offset shift with temperature..... 0.002°/°C
Accuracy
Range
0.1 deg ±40 deg
0.3 deg ±70 deg
0.4 deg ±85 deg
monotonic ±90 deg
Temperature Sensor.....resolution 0.1°C
Communication.....RS485 half duplex (max
tested distance 200m
Baud rate 9600, E, 8 bits 1 stop
Output hex format
(except command 0x50) XXXX in 100th degrees
Cable length.....12 inch
HousingIP66
(For communication see Doc# SAN-222-4114)



Electrical Connections

Connector C10036

Wire Color	Signal name	DB9 Female Connector pin
Black	GND	5
Red	Power	N/A
Green	B (+)	3
White or Yellow	A (-)	2

Ordering Information

Part Number: SSY0271



NOTE: ALL DIMENSIONS $\pm 0.010"$ (0.25MM)

Physical Dimensions

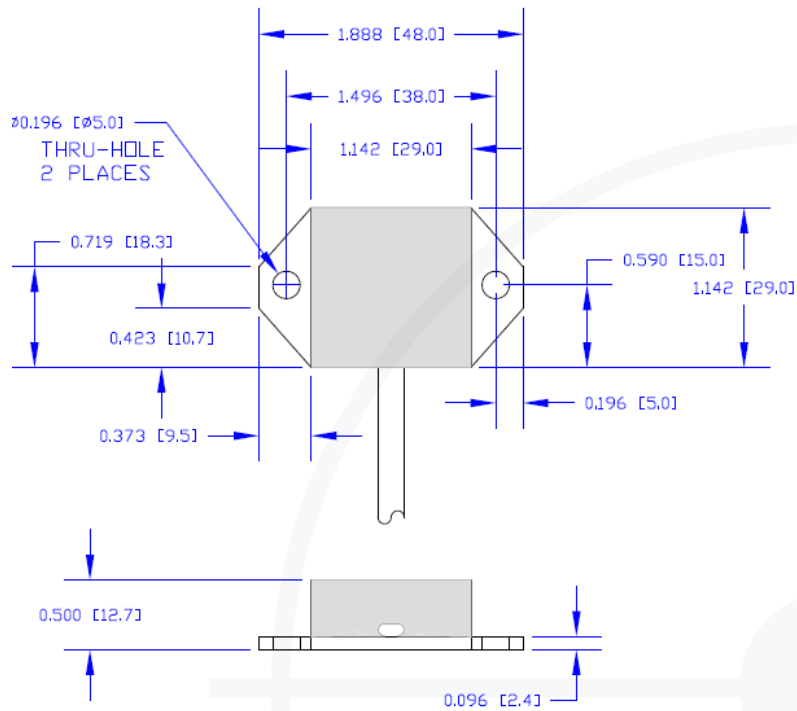

Measuring Directions

